**■ Specifications**

- Contact resistance: $\leq 10\text{m}\Omega$
- Insulation resistance: $\geq 1000\text{M}\Omega$
- Rated voltage: 250V AC DC
- Rated current: 7.0A AC DC
- Withstand voltage: 1500V AC/minute
- Temperature range: $-25^{\circ}\text{C} \sim +85^{\circ}\text{C}$

■ Assembly Layout

P.C.B LAYOUT

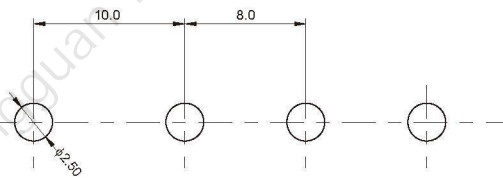
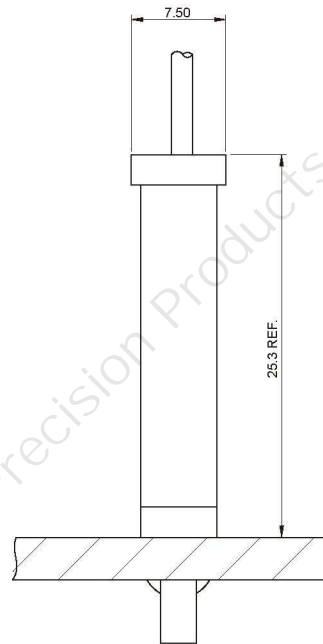

A1080A (10.0-8.0mm pitch 180° Wafer DIP TYPE)

- Reference Information:
- Material: Pin: Brass/Tin-plated
- Wafer: PA66,UL94V-0(2)
- Mates with A1080 series Housing

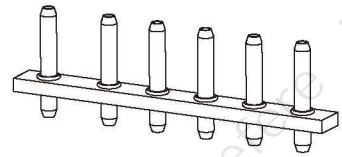
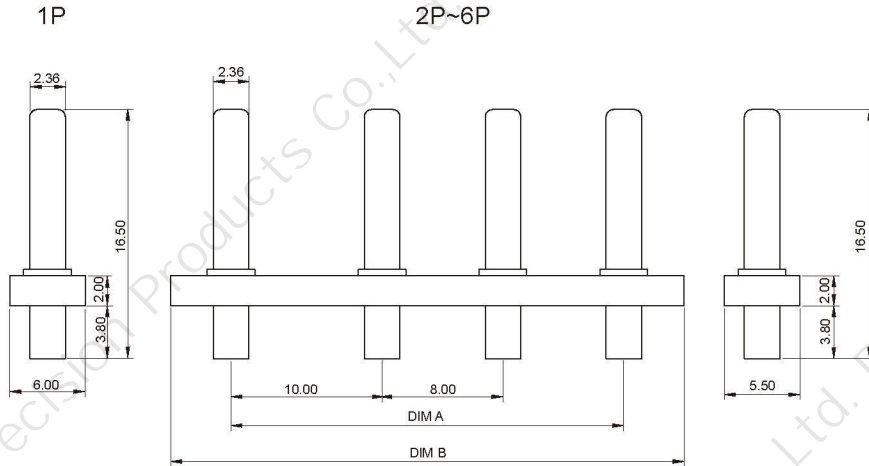

Ordering Information & Dimensions:

Circuit	Dimensions(mm)	
	A	B
02	10.00	18.20
03	18.00	26.20
04	26.00	34.30
05	34.00	42.80
06	42.00	51.00

A1080Y (10.0-8.0mm pitch Housing)

- Reference Information:
- Material: PA66,UL94V-0(2)
- Mates with A1080 series Wafer

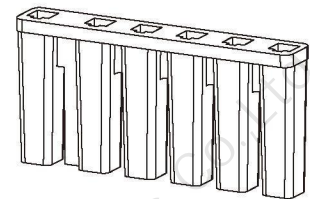
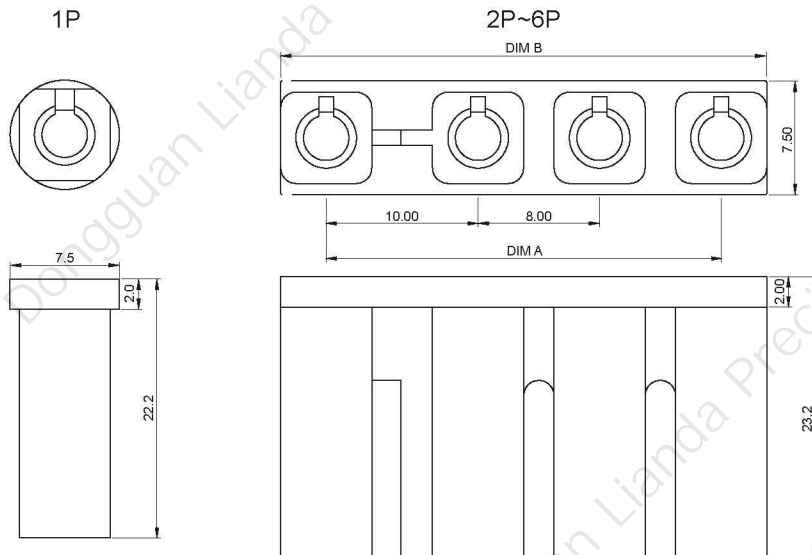

Ordering Information & Dimensions:

Circuit	Dimensions(mm)	
	A	B
02	10.00	16.00
03	18.00	24.00
04	26.00	32.00
05	34.00	40.60
06	42.00	48.70

A1080T (10.0-8.0mm pitch Terminal)

- Reference Information:
Used in A1080 series Housing

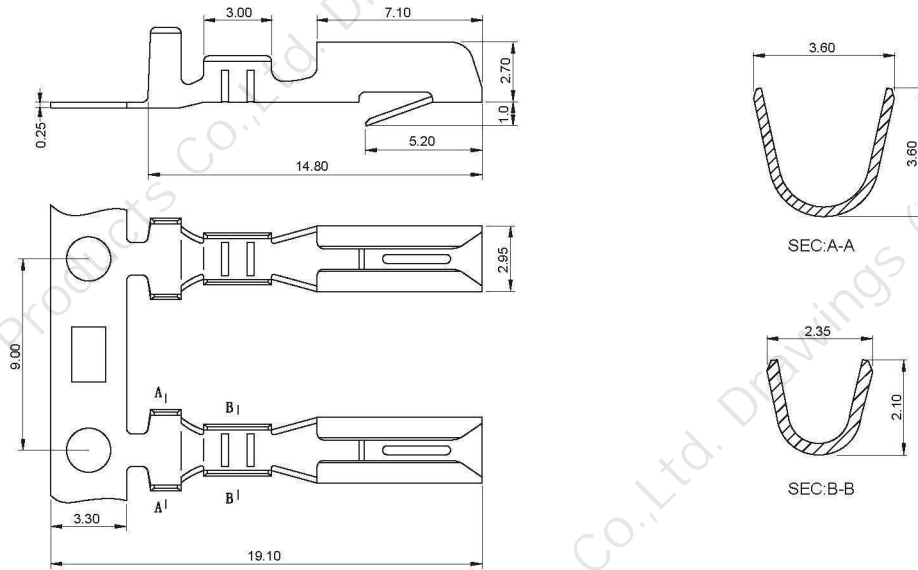

Ordering Information & Dimensions:

Part No	Wire Range	Insulation O.D.	Material	Finish	Qty/Reel
A1080T	AWG #18~#24	3.20mm(max)	Phosphor bronze	Tin-plated	4500PCS