

SPECIFICATION

MATERIAL:

Housing: PBT+30%G. F UL94V-0

Contacts: Copper Alloy

ELECTRICAL:

Current rating: 2 Amps .

Contact resistance: 20 mΩ initial

Insulation resistance: 1000 MΩ min @ 500 VDC

Dielectric withstanding voltage: 1000 VAC/minute

Operating temperature: -55° C TO +125° C

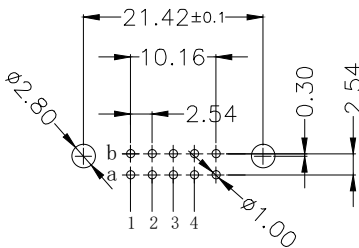
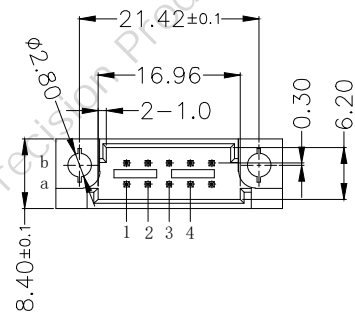
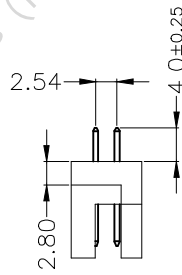
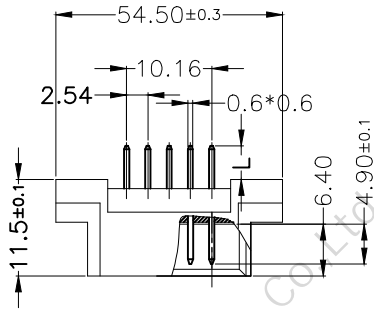

PCB LAYOUT(RECOMMENDED)

(TOP VIEW TOL. :±0.05)

| Length | 1 | 2 | W1 | |
|--------|----------|--------------------|-----------------|--|
| L | 4.0 | 2.5 | 13 | |
| Pitch | Position | Rows with Contacts | Contact Arrange | |
| 2.54 | 10 | A B | | |
| | 5 | A - | | |
| 5.08 | 6 | A B | | |
| | 3 | A - | | |

| 公差一览表 TOLERANCE UNLESS OTHERWISE | | | |
|-------------------------------------|--------------|-------|-------|
| X. | ±0.25 | X°. | ±5° |
| .X | ±0.20 | .X° | ±2° |
| .XX | ±0.15 | .XX° | ±1° |
| .XXX | ±0.02 | .XXX° | ±0.5° |
| 日期 Date | 2009. 04. 15 | | |

欧式插座DIN 41612 210直针公座

SPECIFICATION

MATERIAL:

Housing: PBT+30%G. F UL94V-0
 Contacts: Copper Alloy

ELECTRICAL:

Current rating: 2 Amps .
 Contact resistance: 20 mΩ initial
 Insulation resistance: 1000 MΩ min @ 500 VDC
 Dielectric withstanding voltage: 1000 VAC/minute
 Operating temperature: -55° C TO +125° C

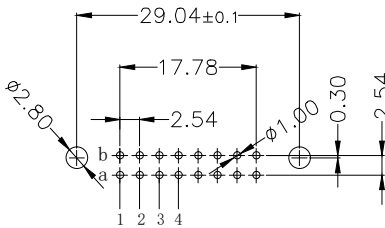
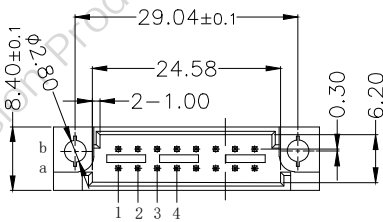
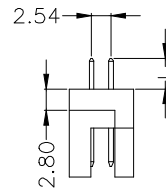
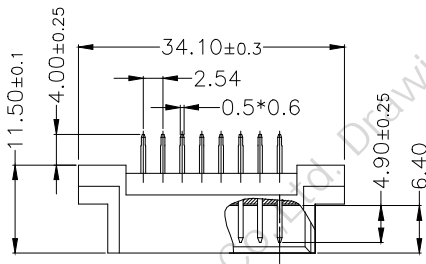

PCB LAYOUT(RECOMMENDED)
 (TOP VIEW TOL. :±0.05)

| Length | 1 | 2 | W1 |
|--------|----------|--------------------|-----------------|
| L | 4.0 | 2.5 | 13 |
| Pitch | Position | Rows with Contacts | Contact Arrange |
| 2.54 | 16 | A B | |
| | 8 | A - | |
| 5.08 | 8 | A B | |
| | 4 | A - | |

| 公差一览表 TOLERANCE UNLESS OTHERWISE | | | |
|-------------------------------------|--------------|-------|-------|
| X. | ±0.25 | X° | ±5° |
| .X | ±0.20 | .X° | ±2° |
| .XX | ±0.15 | .XX° | ±1° |
| .XXX | ±0.02 | .XXX° | ±0.5° |
| 日期 Date | 2009. 04. 15 | | |

欧式插座DIN 41612 216直针公座

SPECIFICATION

MATERIAL:

Housing: PBT+30%G. F UL94V-0
 Contacts: Copper Alloy

ELECTRICAL:

Current rating: 2 Amps .
 Contact resistance: 20 mΩ initial
 Insulation resistance: 1000 MΩ min @ 500 VDC
 Dielectric withstanding voltage: 1000 VAC/minute
 Operating temperature: -55° C TO +125° C

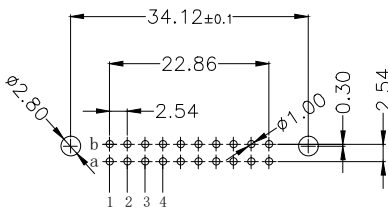
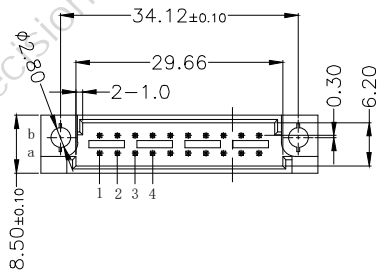
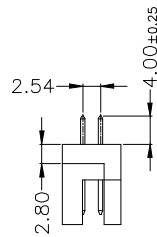
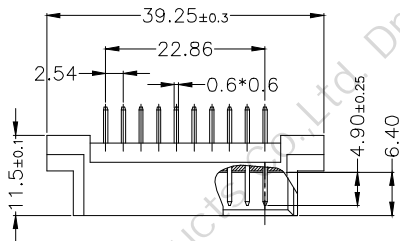

PCB LAYOUT(RECOMMENDED)
 (TOP VIEW TOL. :±0.05)

| Length | 1 | 2 | W1 |
|--------|----------|--------------------|-----------------|
| L | 4.0 | 2.5 | 13 |
| Pitch | Position | Rows with Contacts | Contact Arrange |
| 2.54 | 20 | A B | |
| | 10 | A - | |
| 5.08 | 10 | A B | |
| | 5 | A - | |

| 公差一览表 TOLERANCE UNLESS OTHERWISE | | | |
|-------------------------------------|--------------|-------|-------|
| X. | ±0.25 | X° | ±5° |
| .X | ±0.20 | .X° | ±2° |
| .XX | ±0.15 | .XX° | ±1° |
| .XXX | ±0.02 | .XXX° | ±0.5° |
| 日期 Date | 2009. 04. 15 | | |

欧式插座DIN 41612 220直针公座

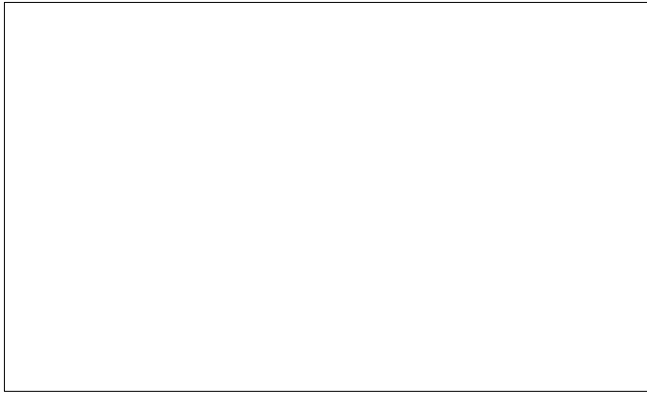

SPECIFICATION

MATERIAL:

Housing: PBT+30%G. F UL94V-0
 Contacts: Copper Alloy

ELECTRICAL:

Current rating: 2 Amps .
 Contact resistance: 20 mΩ initial
 Insulation resistance: 1000 MΩ min @ 500 VDC
 Dielectric withstanding voltage: 1000 VAC/minute
 Operating temperature: -55° C TO +125° C

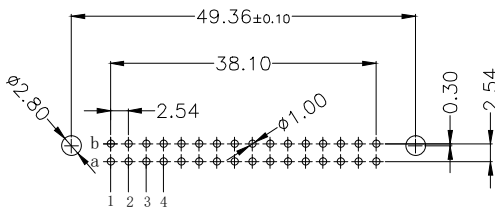
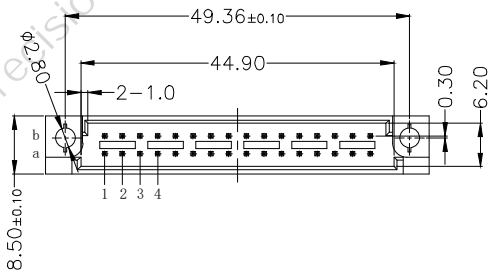
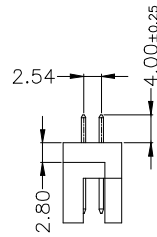
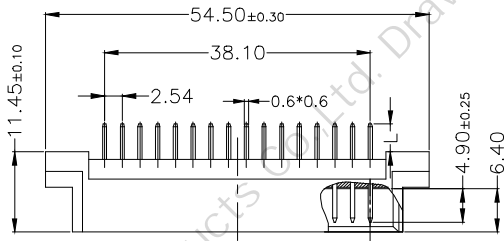

PCB LAYOUT(RECOMMENDED)
 (TOP VIEW TOL. :±0.05)

| Length | 1 | 2 | W1 | |
|--------|----------|--------------------|-----------------|--|
| L | 4.0 | 2.5 | 13 | |
| Pitch | Position | Rows with Contacts | Contact Arrange | |
| 2.54 | 32 | A B | | |
| | 16 | A - | | |
| 5.08 | 16 | A B | | |
| | 8 | A - | | |

| 公差一览表 TOLERANCE UNLESS OTHERWISE | | | |
|-------------------------------------|--------------|-------|-------|
| X. | ±0.25 | X°. | ±5° |
| .X | ±0.20 | .X° | ±2° |
| .XX | ±0.15 | .XX° | ±1° |
| .XXX | ±0.02 | .XXX° | ±0.5° |
| 日期 Date | 2009. 04. 15 | | |

欧式插座DIN 41612 232直针公座

SPECIFICATION

MATERIAL:

Housing: PBT+30%G. F UL94V-0
 Contacts: Copper Alloy

ELECTRICAL:

Current rating: 2 Amps .
 Contact resistance: 20 mΩ initial
 Insulation resistance: 1000 MΩ min @ 500 VDC
 Dielectric withstanding voltage: 1000 VAC/minute
 Operating temperature: -55° C TO +125° C

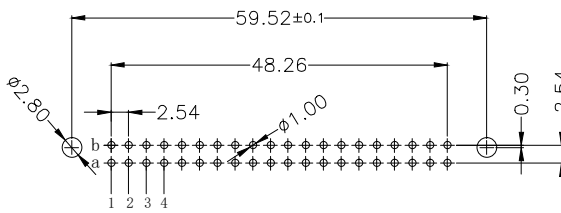
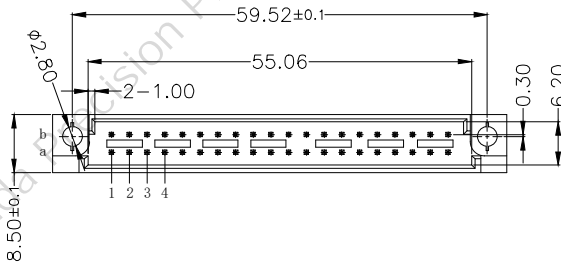
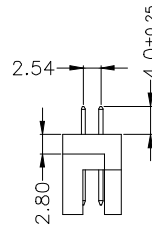
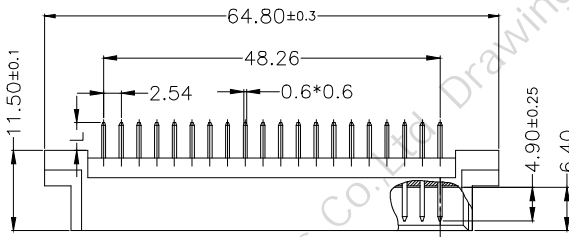

PCB LAYOUT(RECOMMENDED)
 (TOP VIEW TOL. :±0.05)

| Length | 1 | 2 | W1 |
|--------|----------|--------------------|-----------------|
| L | 4.0 | 2.5 | 13 |
| Pitch | Position | Rows with Contacts | Contact Arrange |
| 2.54 | 40 | A B | |
| | 20 | A - | |
| 5.08 | 20 | A B | |
| | 10 | A - | |

| 公差一览表 TOLERANCE UNLESS OTHERWISE | | | |
|-------------------------------------|------------|-------|-------|
| X. | ±0.25 | X° | ±5° |
| .X | ±0.20 | .X° | ±2° |
| .XX | ±0.15 | .XX° | ±1° |
| .XXX | ±0.02 | .XXX° | ±0.5° |
| 日期 Date | 2021-10-19 | | |

欧式插座DIN 41612 240直针公座

SPECIFICATION

MATERIAL:

Housing: PBT+30%G. F UL94V-0
 Contacts: Copper Alloy

ELECTRICAL:

Current rating: 2 Amps .
 Contact resistance: 20 mΩ initial
 Insulation resistance: 1000 MΩ min @ 500 VDC
 Dielectric withstanding voltage: 1000 VAC/minute
 Operating temperature: -55° C TO +125° C

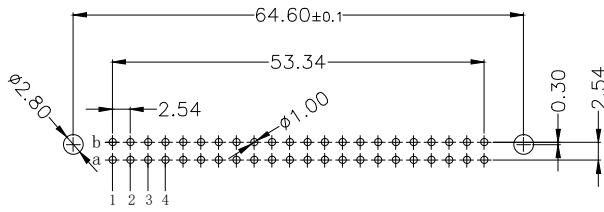
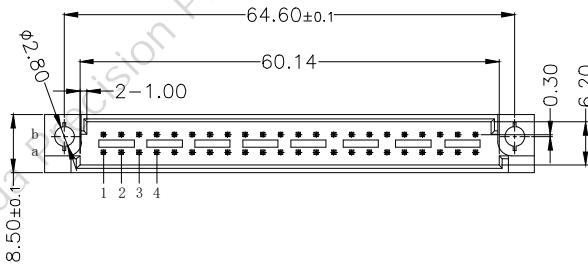
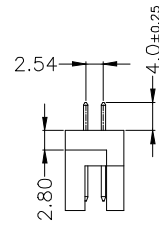
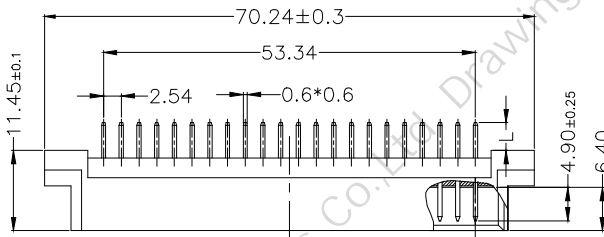

PCB LAYOUT(RECOMMENDED)
 (TOP VIEW TOL. :±0.05)

| Length | 1 | 2 | W1 | |
|--------|----------|--------------------|-----------------|--|
| L | 4.0 | 2.5 | 13 | |
| Pitch | Position | Rows with Contacts | Contact Arrange | |
| 2.54 | 44 | A B | | |
| | 22 | A - | | |
| 5.08 | 22 | A B | | |
| | 11 | A - | | |

| 公差一览表 TOLERANCE UNLESS OTHERWISE | | | |
|-------------------------------------|--------------|-------|-------|
| X. | ±0.25 | X° | ±5° |
| .X | ±0.20 | .X° | ±2° |
| .XX | ±0.15 | .XX° | ±1° |
| .XXX | ±0.02 | .XXX° | ±0.5° |
| 日期 Date | 2009. 04. 15 | | |

欧式插座DIN 41612 244直针公座

SPECIFICATION

MATERIAL:

Housing: PBT+30%G. F UL94V-0
 Contacts: Copper Alloy

ELECTRICAL:

Current rating: 2 Amps .
 Contact resistance: 20 mΩ initial
 Insulation resistance: 1000 MΩ min @ 500 VDC
 Dielectric withstanding voltage: 1000 VAC/minute
 Operating temperature: -55° C TO +125° C

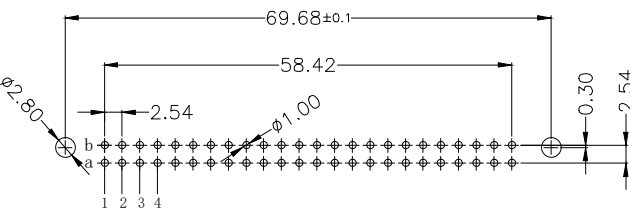
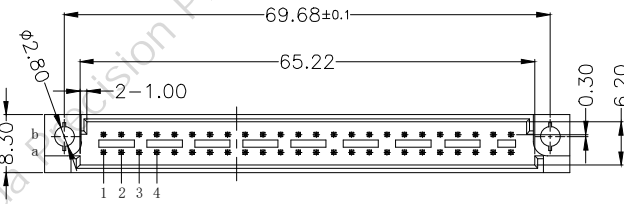
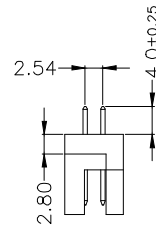
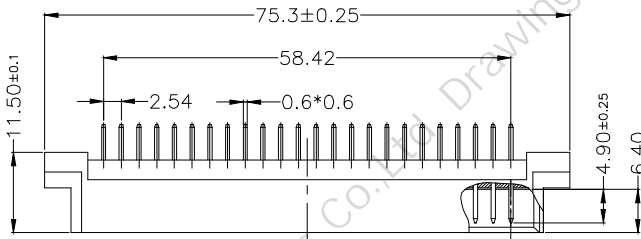

PCB LAYOUT(RECOMMENDED)
 (TOP VIEW TOL. :±0.05)

| Length | 1 | 2 | W1 | |
|--------|----------|--------------------|-----------------|--|
| L | 4.0 | 2.5 | 13 | |
| Pitch | Position | Rows with Contacts | Contact Arrange | |
| 2.54 | 44 | A B | | |
| | 22 | A - | | |
| 5.08 | 22 | A B | | |
| | 11 | A - | | |

| 公差一览表 TOLERANCE UNLESS OTHERWISE | | | |
|-------------------------------------|--------------|-------|-------|
| X. | ±0.25 | X° | ±5° |
| .X | ±0.20 | .X° | ±2° |
| .XX | ±0.15 | .XX° | ±1° |
| .XXX | ±0.02 | .XXX° | ±0.5° |
| 日期 Date | 2009. 04. 15 | | |

欧式插座DIN 41612 248直针公座

SPECIFICATION

MATERIAL:

Housing: PBT+30%G. F UL94V-0
 Contacts: Copper Alloy

ELECTRICAL:

Current rating: 2 Amps .
 Contact resistance: 20 mΩ initial
 Insulation resistance: 1000 MΩ min @ 500 VDC
 Dielectric withstanding voltage: 1000 VAC/minute
 Operating temperature: -55° C TO +125° C

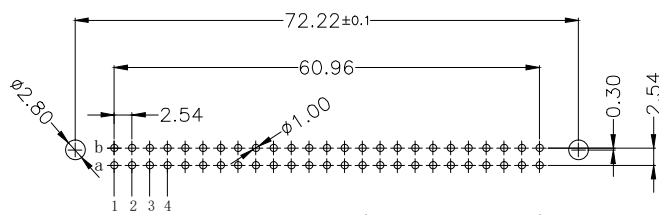
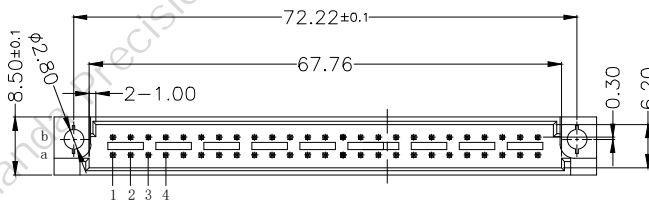
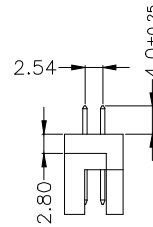
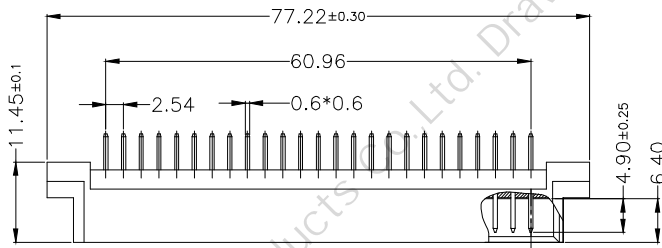

PCB LAYOUT(RECOMMENDED)
 (TOP VIEW TOL. :±0.05)

| Pitch | Position | Rows with Contacts | Contact Arrange |
|-------|----------|--------------------|-----------------|
| 2.54 | 50 | A B | |
| | 25 | A - | |
| 5.08 | 26 | A B | |
| | 13 | A - | |

| 公差一览表 TOLERANCE UNLESS OTHERWISE | | | |
|-------------------------------------|--------------|-------|-------|
| X. | ±0.25 | X° | ±5° |
| .X | ±0.20 | .X° | ±2° |
| .XX | ±0.15 | .XX° | ±1° |
| .XXX | ±0.02 | .XXX° | ±0.5° |
| 日期 Date | 2009. 04. 15 | | |

欧式插座DIN 41612 250直针公座

SPECIFICATION

MATERIAL:

Housing: PBT+30%G. F UL94V-0
 Contacts: Copper Alloy

ELECTRICAL:

Current rating: 2 Amps .
 Contact resistance: 20 mΩ initial
 Insulation resistance: 1000 MΩ min @ 500 VDC
 Dielectric withstanding voltage: 1000 VAC/minute
 Operating temperature: -55° C TO +125° C

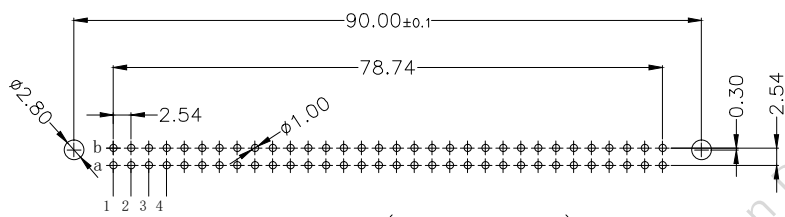
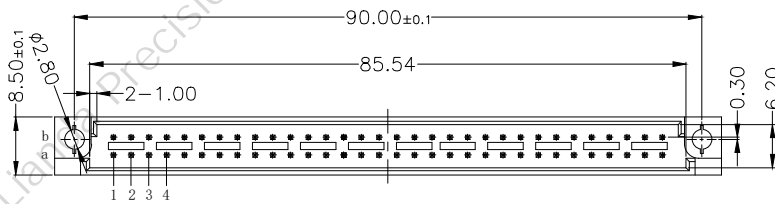
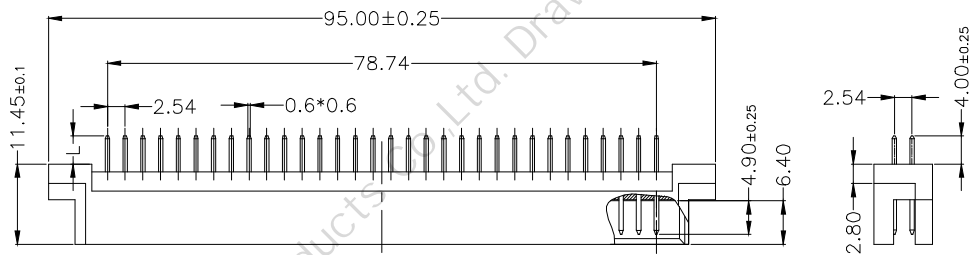

PCB LAYOUT(RECOMMENDED)
 (TOP VIEW TOL. :±0.05)

| Length | 1 | 2 | WI |
|--------|----------|--------------------|-----------------|
| L | 4.0 | 2.5 | 13 |
| Pitch | Position | Rows with Contacts | Contact Arrange |
| 2.54 | 64 | A B | |
| | 32 | A - | |
| 5.08 | 32 | A B | |
| | 16 | A - | |

| 公差一览表 TOLERANCE UNLESS OTHERWISE | | | |
|-------------------------------------|--------------|-------|-------|
| X. | ±0.25 | X° | ±5° |
| .X | ±0.20 | .X° | ±2° |
| .XX | ±0.15 | .XX° | ±1° |
| .XXX | ±0.02 | .XXX° | ±0.5° |
| 日期 Date | 2009. 04. 15 | | |

欧式插座DIN 41612 264直针公座